



Compact kiosk printer for
wide format documents
- full A4 or Letter paper width

- A4 or Letter width printouts
- Loop presenter
- Pull detector
- Retract & retain
- Fast 100 mm/s print speed
- Easy paper path access
- Large roll capacity: 250 mm OD
- Roll or fanfold stock

professional
printer
solutions



TTP 8000 A4/Ltr Kiosk printer

The Zebra TTP 8200 is robust, simple and extremely reliable. It can handle unfriendly environments, e.g. cold, heat, strong vibrations. Its only consumable is paper (on rolls or fanfold), and it requires minimal maintenance. The TTP 8200 offers practical functions such as a built-in paper cutter and a presenter, which keeps the paper inside the printer and feeds it out only after printing is completed, thereby reducing the risk of error. The user can not pull the printout until printing is completed.

The TTP 8200 is a complete flexible printing concept. Every aspect of kiosk printing is addressed, from mounting position, to paper handling, to power supply, and much more. For instance the available roll holders make it possible to fit rolls of up to 150 mm behind the printer, but also both 150 mm and 250 mm rolls under the printer. The ingenious roll holder fits both roll sizes without being larger than a 150 mm holder. There is no limitation to kiosk design when using a Zebra kiosk printer.

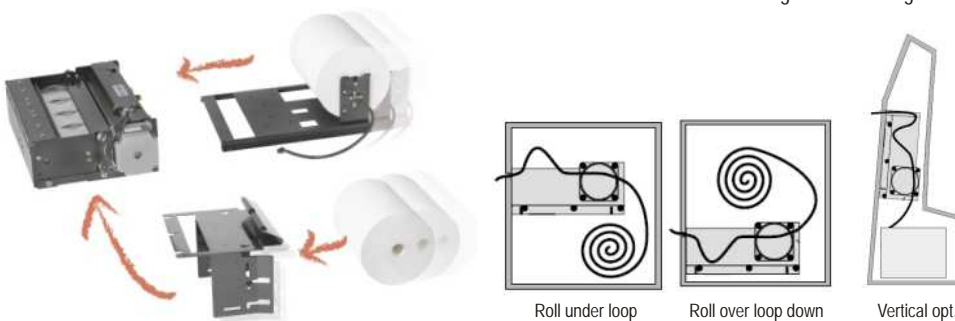

Application examples

- Internet kiosks
- Information terminals
- Multimedia kiosks
- ATM / bank statements
- Form printing
- Employment kiosks
- Human resource kiosks

GENERAL

| | |
|-----------------|--|
| Printer control | Windows and Linux drivers. Direct addressing through ESC sequences |
| Print method | Direct thermal line printing |
| Print width | 216 mm (1728 dots) |
| Resolution | 203 or 300 dpi (8 or 12 dots/mm) |
| Print speed | Up to 100 mm/s |
| Interfaces | Parallel IEEE-1284 and USB. Optional external RS-232 serial interface. |
| Cutter | Guillotine cutter. |

TEXT MODE

| | |
|-----------------|--|
| Orientation | Portrait or landscape mode |
| Type fonts | 8 bitmap fonts can be stored. |
| Text attributes | Underline, Bold, Italics, reverse print, multiple width and height |
| Character set* | Windows Code Page 1252 (Western) |
| Bar codes | Code 39 (font), other bar codes on request |
| Graphics | Logotypes and b&w BMP-files |

PAPER

| | |
|-------------------|--|
| Paper supply | Roll or fanfold paper |
| Paper width | A4 (210 mm) or Letter (8.5") |
| Image life | More than 25 years with appropriate paper |
| Roll diameter | 250 mm max |
| Spindle diameter | 25 mm minimum |
| Printout length | Variable, no upper limit, minimum 200 mm - A4 (297 mm) - Letter (11") |
| Paper weight | 55 – 110 g/m ² (0.054 – 0.1 mm) |
| Looping presenter | Stores the printout until printed and cut. Pull-Detector, Exact eject length (6 mm steps) & Retract & Retain function. |
| Optical sensors: | Out of paper, paper near end (optional) and weekend level sensor (optional). Black mark. |
| Switch sensors: | Cutter in home position, printhead lifted. |

MISCELLANEOUS

| | |
|--------------------|---|
| Typical throughput | 14 pages / minute (A4 length) |
| Environment | Operating: 0 to +50°C Storage: -20 to +60 °C Operating: 35 to 75% RH, non-condensing Storage: 10 to 90% RH, non-condensing |
| Size | 286 x 78 x 171 mm (w x h x d) Weight 4.8 kg |
| Power requirements | 24Vdc ± 10%. Idle 150mA. Printing average 6A, peak 12A |
| Safety | CE, UL, cUL |

LIFE EXPECTANCY / MTBF

| | |
|---------------|--|
| Printhead | More than 50 km paper More than 1x10 ⁹ pulse lines (typically) |
| Control board | 40 000 hours (typically) |
| Cutter | 500 000 cuts (typically) |
| MTBF | 170 000 printouts (typically) |

GRAPHICS MODE (Windows & Linux)

TTP 8000 can print any font, code-page, bar code, and graphics supported by the operating system

* 224-characters of a TrueType-font can be converted to SWC format and stored in printer



| | EUROPEAN HEAD QUARTERS | USA |
|----------|---|--|
| ADDRESS | Swecoin AB, Box 322 SE-192 30 Sollentuna, SWEDEN | Swecoin US Inc. 30 Plan Way Warwick, RI 02886-1012, USA |
| VISITORS | Bergkällavägen 32, Sollentuna | |
| PHONE | +46 8 623 45 60 | +1 800-556-7266 |
| FAX | +46 8 594 709 89 | +1 401-739-3435 |
| E-MAIL | mseurope@zebra.com EMEAKioskTech@zebra.com | SwecoinSales@zebra.com SwecoinTechSupport@zebra.com |
| WEBSITE | www.zebra.com | www.zebra.com |